

JAMES T. GUARINO
CONSULTING

ARCHITECTS
BUILDING
INFORMATION
MODELING

James T. Guarino, AIA,
60 North Main Street
Sherborn, MA. 01770-1513
617-699-0991
www.jamestguarino.com



Equestrian Facility

Mike Newman Polly Komblith
16 Nason Hill Lane
Sherborn, MA.

ARCHITECT'S PROJECT No.
17001.00

COPYRIGHT 2017 JAMES T. GUARINO CONSULTING

PROJECT NORTH MAGNETIC NORTH



FIRST FLOOR
BARN PLAN -
PROGRESS

DATE:
02/04/17
SCALE:
1/8" = 1'-0"

DRAWING
NUMBER
PL-3

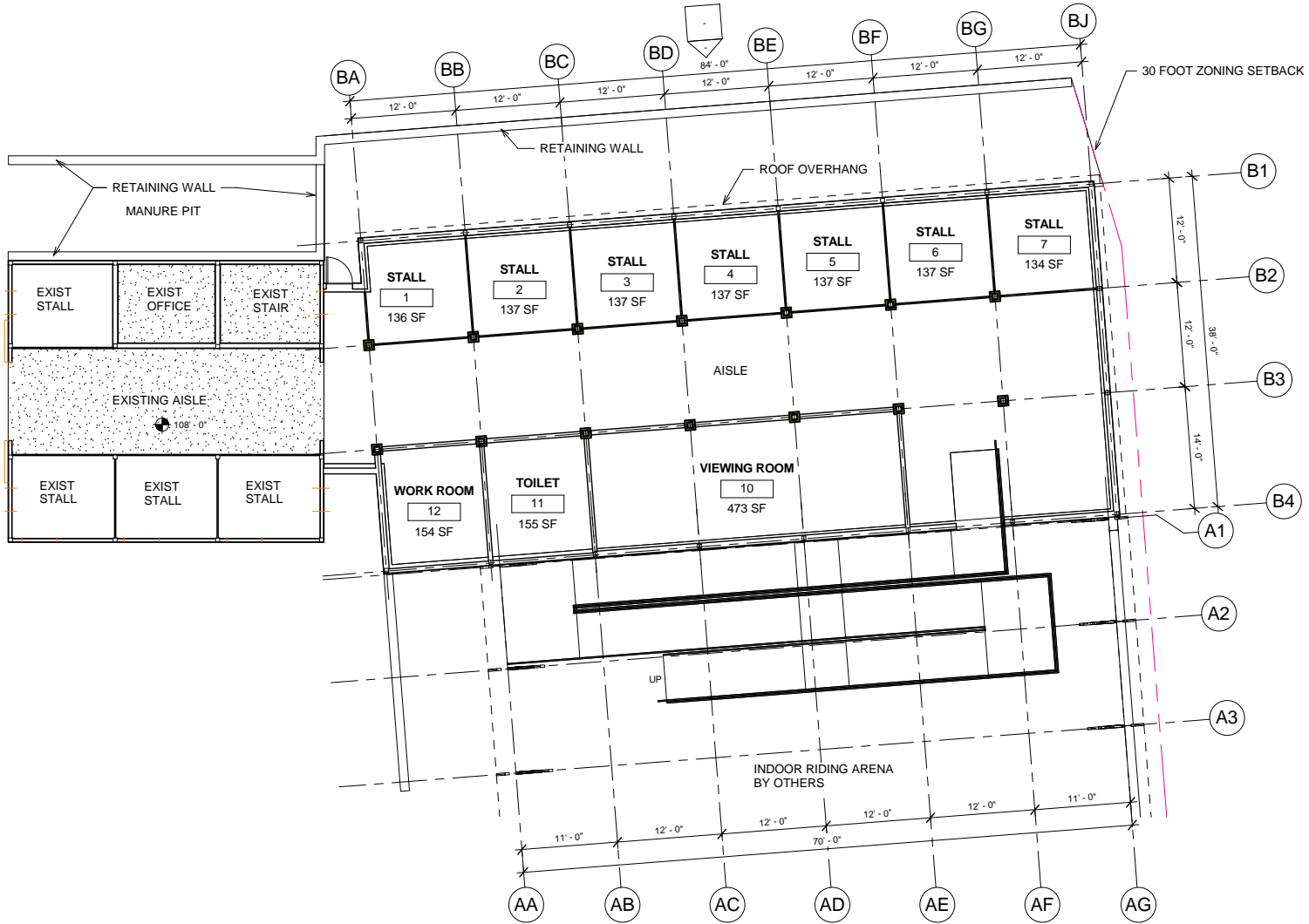

1 BARN LEVEL 1 - ENLARGED
1/8" = 1'-0"